

TO LET

Grosvenor Court Irving Road,
Hammersmith, W14

Flat
Hammersmith

£495 p/w

2  1  1 



**horton
andgarton**

SALES / LETTINGS / PROPERTY MANAGEMENT

hortonandgarton.co.uk | Sales 020 8819 0510 | Lettings 020 8819 0511
172 King Street, Hammersmith, W6 0QU



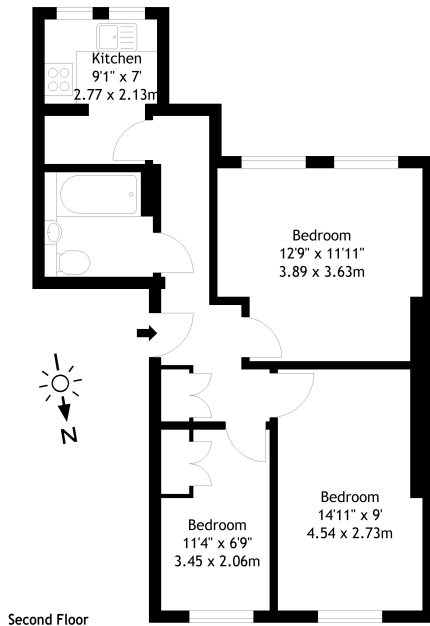

**horton
andgarton**

15 Grosvenor Court,
23 Irving Road, W14 0JU

Gross Internal Area 554.2 sq m - 554.36 sq ft -

Drawn from supplied plans. All measurements are approximate.
This floor plan is for illustrative purposes only and is not to scale.
© Horton and Garton Estate Agents 2024



Two double bedroom flat | Original features found throughout | Part-furnished | Access to Communal Gardens | EPC rating tbc | Brook Green



hortonandgarton.co.uk
Sales 020 8819 0510
Lettings 020 8819 0511

172 King Street, Hammersmith, W6 0QU