

FOR SALE

Bollingbroke Road,
Brook Green, W14

Flat
West London

£400,000 lh

1  1  1 



**horton
andgarton**

SALES / LETTINGS / PROPERTY MANAGEMENT

hortonandgarton.co.uk | Sales 020 8819 0510 | Lettings 020 8819 0511
172 King Street, Hammersmith, W6 0QU



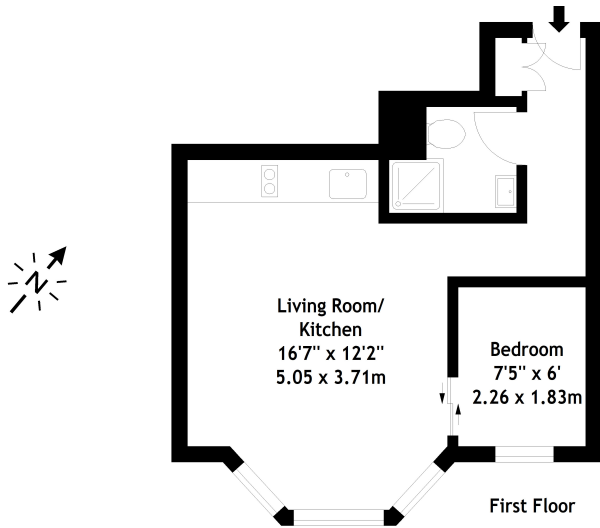

Flat 3,
20 Bollingbroke Road,
London,
W14 0AL

Gross Internal Area 315 sq ft - 29.26 sq m
 Drawn from supplied plans.
 All measurements are approximate.
 This floor plan is for illustrative purposes only
 and is not to scale.
 © Horton and Garton Estate Agents 2024

**horton
and garton**



Stylish studio apartment | High specification fittings
 throughout | 315 Sq' - 29.6 SqM | Highly accessible
 location | EPC rating C | Brook Green / Olympia



hortonandgarton.co.uk
 Sales 020 8819 0510
 Lettings 020 8819 0511

172 King Street, Hammersmith, W6 0QU