

FOR SALE

Overstone Road,
Hammersmith, W6

Flat
Brackenbury Village

£450,000 sh of fh

1  1  1 



**horton
andgarton**

SALES / LETTINGS / PROPERTY MANAGEMENT

hortonandgarton.co.uk | Sales 020 8819 0510 | Lettings 020 8819 0511
172 King Street, Hammersmith, W6 0QU



Overstone Road, W6

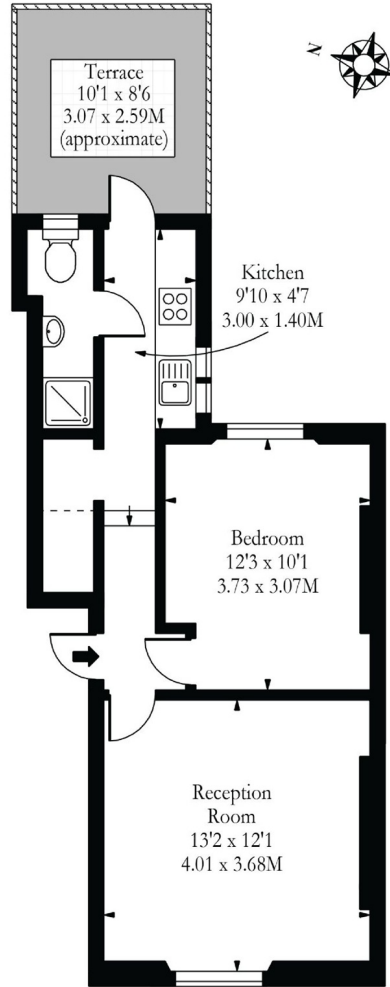

Ground Floor

Approx Gross Internal Area 423 Sq Ft - 39.30 Sq M

Illustration Purposes Only

Whilst every attempt has been made to ensure the accuracy of the floor plan contained here, measurements of doors, windows, rooms and any other items are approximate and no responsibility is taken for any errors, omissions or mis-statements. The plan is for illustrative purposes only, is not to scale and should be used as such by any prospective purchaser.



Victorian conversion flat | One bedroom - One bathroom
| 423 Sq' - 39.3 SqM | Roof terrace | EPC rating D |
Brackenbury Village



hortonandgarton.co.uk
Sales 020 8819 0510
Lettings 020 8819 0511

172 King Street, Hammersmith, W6 0QU